

1/2/3 Gang Crystal Glass Panel Two Way Touch Switch with LED Indicator US Style

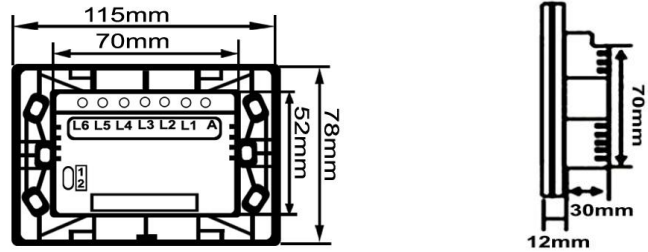

Package Include:

- 1 x Two Way Touch Switch
- 2 x Screws
- 1 x User Manual

Product Specification:

- Dimension: 115mm*78mm*42mm
- Material: Crystal Glass Panel
- Operating Voltage: AC110V~250V/50Hz/60Hz
- Maximum Current for Each Gang: 5A
- Maximum Power for Each Gang: 1000W/220V or 600W/120V
- Self Consuming Power: Less than 0.1mW
- Operating Environment: -30~70 Centigrade; Less than 95%RH
- Lifelong: 100,000 Times of Operation
- Using with all types of lights including Incandescent lamps, Halogen lamps, Fluorescent lamps, Energy saving lamps.

Note: The switch is not suitable for LED lamps or inductive ballast fluorescent, or any lamps with load power lower than 15W.

Switch Operation:

Power on the switch, it will enter into initial status. About 10 seconds later, you can operate the switch.
The two way switch only works after matching each other.

1 Gang Switch Operation:

Matching steps:

Touch slightly the icon on the switch connected with lamp for 5 seconds; take away your finger when you hear the sound of "Di". Then touch the icon on the other switch, the lamp turns on/off, which means the success of matching.

Matching cancel steps:

Touch the icon of any switch connected with lamp for 10 seconds until hearing two sounds of "Di", and then takes away your finger immediately. All the matching will be cancelled.

Operation:

Touch softly the icon on any one switch surface, the LED indicator turns red, which means turning on the light.
Touch again the icon on any one switch surface, the lamp turns off.

2 gang Switch Operation:

Matching steps:

Touch slightly the icon on the switch connected with lamp for 5 seconds; take away your finger when you hear the sound of "Di". Then touch any icon on the other switch, the lamp turns on/off, which means the success of matching.

Matching cancel steps:

Touch any icon of switch connected with lamp for 10 seconds until hearing two sounds of "Di", and then takes away your finger immediately. All the matching will be cancelled.

Operation:

Touch softly the icon on any one switch surface, the LED indicator turns red, which means turning on the light.
Touch again the icon on any one switch surface, the lamp turns off.

3 gang Switch Operation:

Matching steps:

Touch slightly the icon on the switch connected with lamp for 5 seconds; take away your finger when you hear the sound of "Di". Then touch any icon on the other switch, the lamp turns on/off, which means the success of matching.

Matching cancel steps:

Touch any icon of switch connected with lamp for 10 seconds until hearing two sounds of "Di", and then takes away your finger immediately. All the matching will be cancelled.

Operation:

Touch softly the icon on any one switch surface, the LED indicator turns red, which means turning on the light.
Touch again the icon on any one switch surface, the lamp turns off.

Note:

Please don't take away your finger when you hear one "Di" sound.

The quantity of connected two way switch cannot exceed three.

The total load power can't exceed 1000W for all connected two way switches.

The distance between two sides of A/B can't exceed 30m.

If the switch is not connected with any lamp, there is no sound when matching. Remote function is not available.

Not support remote scene mode.

Installation:

1. Shut off the power to the circuit and remove the switch cover with screwdriver.

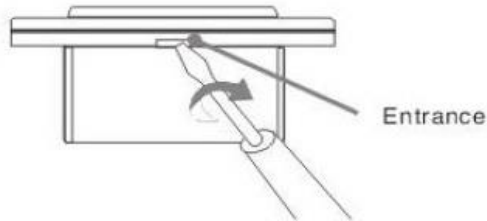

2. Connect the wires to the screw terminals. (Terminal L4, L5 and L6 are not used now.)

1 gang two-way switch controls one light

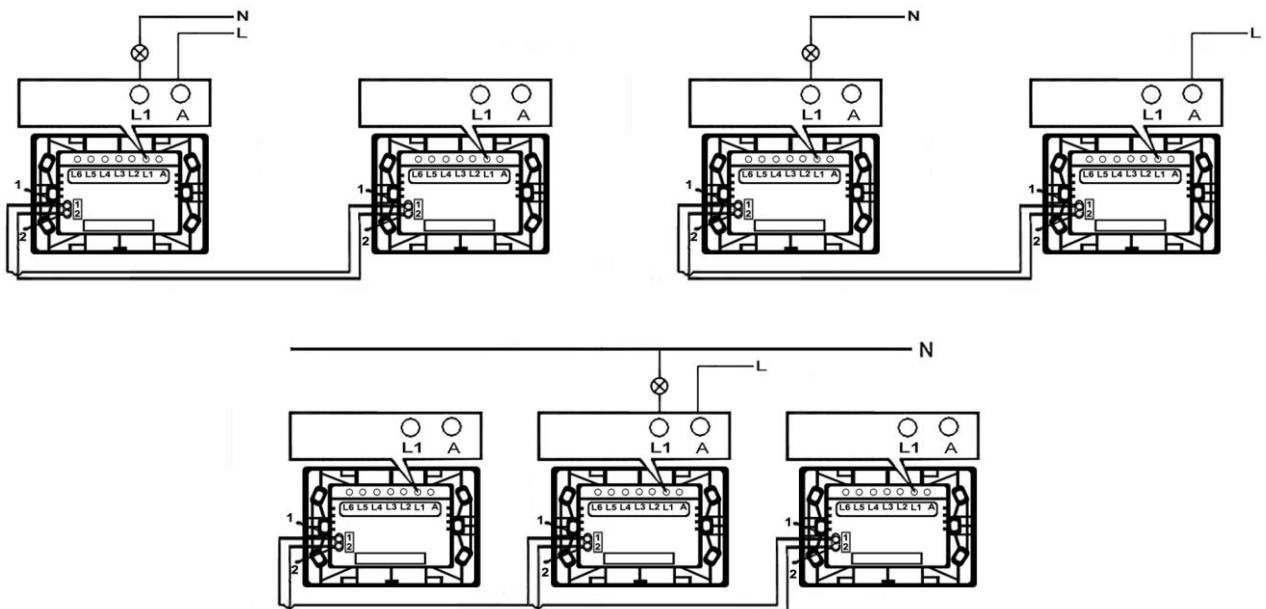

2 gang two-way switch controls two lights

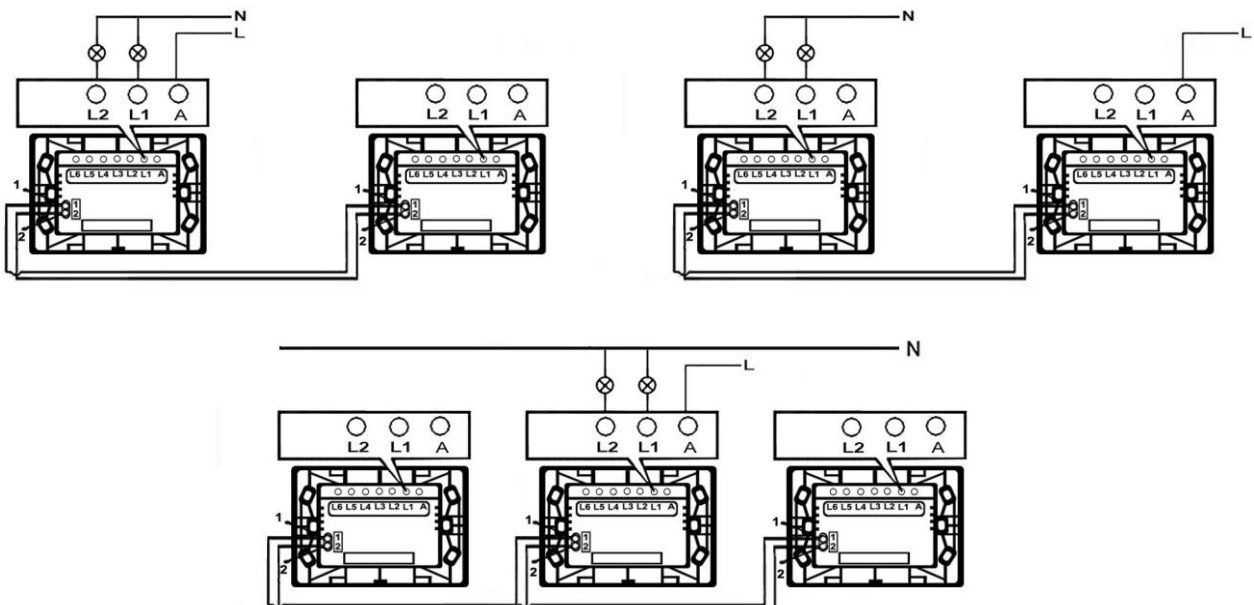

3 gang two-way switch controls three lights

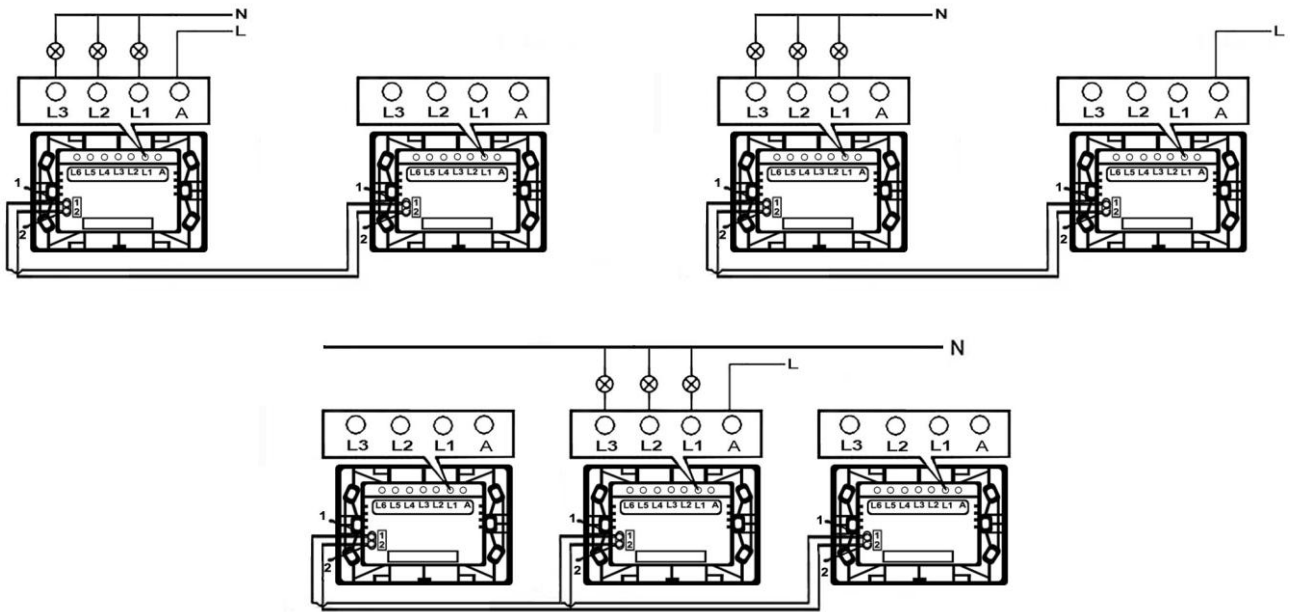

Note:

When one two way switch connects with another, any one switch connected with live wire is enough.

Lamp like L1/L2/L3 can connect with any one of two switches.

Both communication line A & B from one switch should be connected with others. Communication line A from one switch is forbidden to connect B from others, only A to A, B to B.

3. Fix tightly the switch to internal box with two screws.

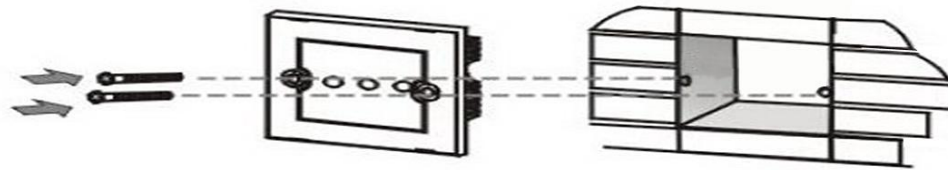

4. Fix the cover.

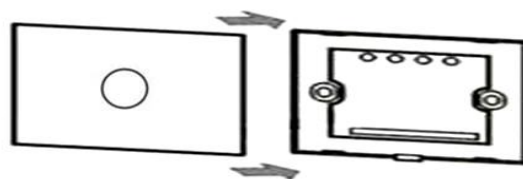

Warning:

1. Please turn off power before installation and dismantlement, especially when fixing the switch cover.
2. After turning on power, you have to wait about 30 seconds before operating the switch.
3. Doing the Installation and dismantlement must be professional.
4. Check the circle condition before installation.
5. Pay an attention to the lamp introduction, since some lamps have special condition.
6. Dismantle the product to avoid ruin as the circuit is testing.
7. Avoid shock, wateriness, hot, and knocking when installing and using the product.
8. Forbid wet cloth, chemistry and scour water when cleaning.
9. Over loading is forbidden.
10. Circuitry which the products installed in should be set properly.
11. Do not use metal box for installation, it maybe shorten the distance of remote control or cause electric shock.